



### KEY FEATURES

- Coordinate riveting machine with customised belt system and workpiece holder. Complete workstation for integration in transferline.
- Doubles or triples throughput even in small to medium runs
- According to the required riveting force, 4 different riveting units can be applied
- Proportional valve technique makes it easy to handle different rivets in the same workpiece

### PROCESS CONTROL

#### *HPP-25: Process monitoring with integrated riveting controller*

- 5,7" Touchscreen LED-backlit
- Process data are continuously evaluated and stored
- Integrated riveting curve visualization for a simple process analysis
- USB- and Ethernet interfaces and integrated data logger
- Graphical display of riveting force- and deformation path-curve
- Indicator on riveting head home position and lower endposition
- Status display in-/output of the riveting curve

## TECHNICAL DATA

- X axis travel 400mm\*
- Y axis travel 400mm\*
- riveting range 300x200\*
- X/Y axis speed max 350mm/sek

\* other axis travel and/or riveting range on request

## DIMENSIONS AND WEIGHT

- Weight 850kg
- Length 1500mm
- Width 1600mm (without transferbelt)
- Height 2000mm

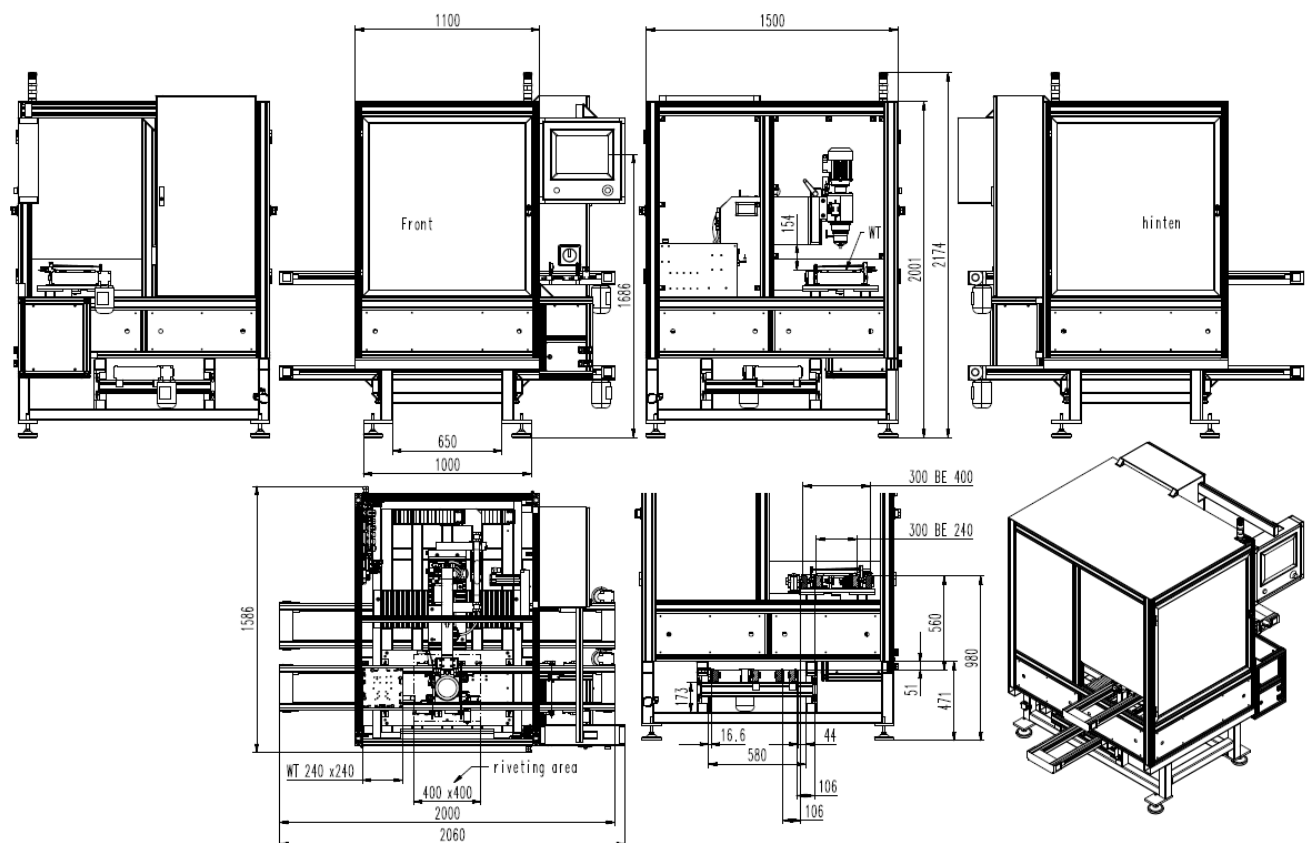

Subject to technical changes

Transferbelt: Is not part of scope of delivery.  
Dimensions vary, depending on the required specification.